



Sheraton Grand

HOTEL & SPA EDINBURGH



Sheraton Grand in Short



Sheraton Grand Hotel & Spa

1 Festival Square
 Edinburgh, EH3 9SR
 T +44 (0) 131 229 9131
sheraton.com/grandedinburgh

EXPLORE

Looking across to Edinburgh Castle, The Sheraton Grand Hotel & Spa has long been a popular destination for visitors and locals alike. Together with the distinctly modern One Square Restaurant & Bar, award winning One Spa, the hotel forms part of a unique gathering place in the heart of the city.

EXPERIENCE

Home to a dedicated meeting and events space with integrated AV technology, natural daylight and its own private entrance from the hotel forecourt. The Sheraton Grand is the largest of any hotel in Edinburgh, and is equally suited to everything from an informal team meeting to a dinner for 600 or lavish reception for 1,000 guests.

STAY

Whatever the reason for your stay, our guest bedrooms are worth talking about. Bright and spacious, these offer mood lighting and opaque glass-walled bathrooms, complete with elegant baths, walk-in showers and a Sheraton Sleep Experience Bed.

THE DETAILS

Guestrooms: 269
 Meeting Spaces: 14
 Features: Club Lounge, Business Centre, Fitness Centre, 19m Indoor Pool, Poolside Sauna, Spa Services, Rooftop Hypropool

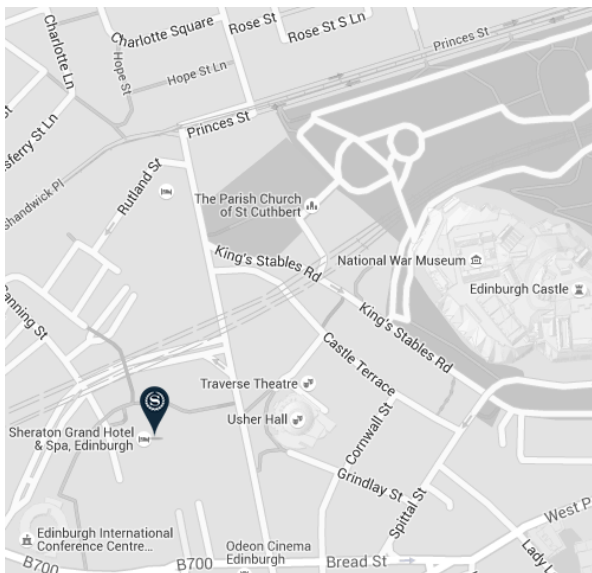

ROOM TYPE	KING	TWIN
Classic Rooms	120	32
Castle View Rooms	49	7
Club Rooms	25	8
Club & Castle View Rooms	14	2
Classic Suite	4	-
Castle Suite	4	-
Club Suite	1	-
Club Castle Suite	1	-
Grand Suite	1	1



Sheraton Grand

HOTEL & SPA EDINBURGH

Meeting Space Overview

SHERATON GRAND HOTEL & SPA BY THE NUMBERS

Total Guestrooms: 269
Total Meeting Rooms: 14
Maximum Capacity: 500
Total Meeting Space: 500m² / 5,382ft²

Additional spaces for meetings and events, not displayed here, may also be available. Contact your hotel representative for more information.

LEVEL 1

Stirling
Stirling 1 & 2 (partitioned)

LEVEL 2

Eilean Donan
Dunvegan
Braemar
Braemar 1 & 2 (partitioned)
Culzean
Culzean 1 & 2 (partitioned)
Glamis
Glamis 1 & 2 (partitioned)
The Atrium
Edinburgh Suite
Edinburgh Suite 1 & 2 (partitioned)
Melville

This document contains approximate measurements and square footage that are for illustrative purposes only. We cannot guarantee the floor plan accuracy or completeness, therefore encourage you to review the space to make sure it is suitable for your event.

SHERATON GRAND HOTEL & SPA

1 Festival Square
Edinburgh, EH3 9SR
T +44 (0) 131 229 9131
sheraton.com/grandedinburgh

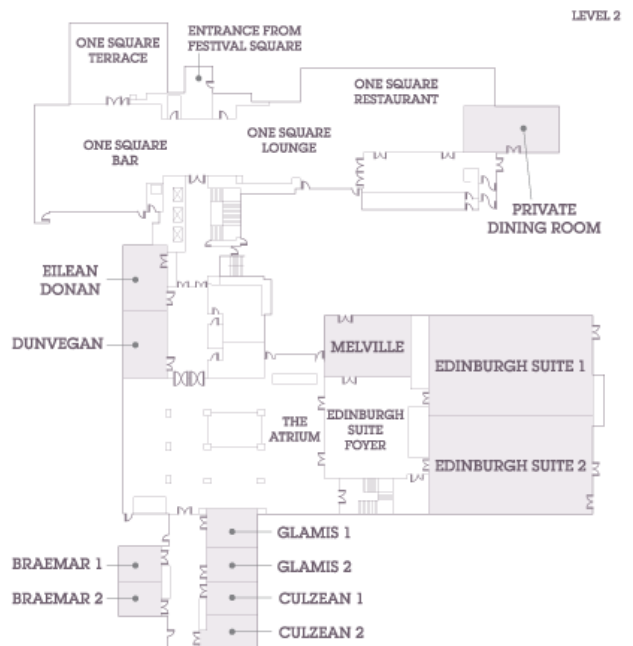
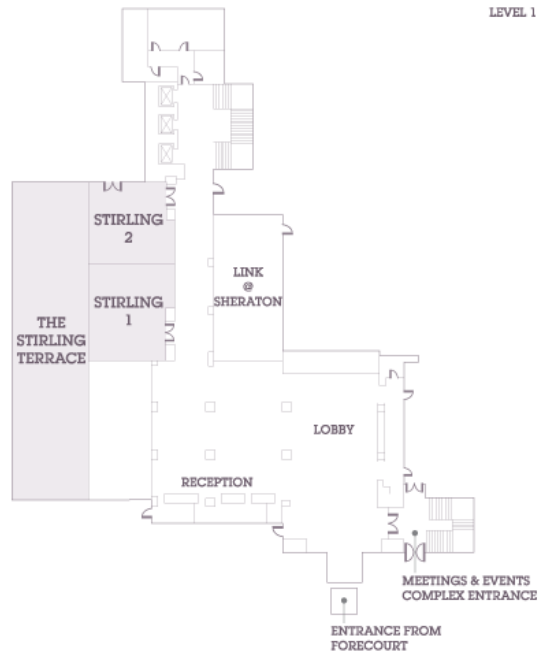



Sheraton Grand

HOTEL & SPA EDINBURGH

Capacity Chart

	SQUARE FEET/ METRE	DIMENSIONS (Feet)	HEIGHT (Feet)	BOARD ROOM	U-SHAPE	CABARET (8 PER TABLE)	THEATRE	CLASS ROOM (3 PER TABLE)	DINNER
EDINBURGH SUITE	5468 / 508	66.9 x 81.7	12.1	120	80	384	500	350	500
EDINBURGH 1 & 2	2723 / 253	66.9 x 40	12.1	80	60	184	240	180	240
MELVILLE	872 / 81	25.6 x 34.1	9.2	28	29	48	90	51	70
EILEAN DONAN	431 / 40	16.4 x 26.2	9.2	20	N/A	N/A	N/A	N/A	N/A
DUNVEGAN	495 / 46	18 x 27.2	9.2	20	17	24	42	18	30
CULZEAN	484 / 45	25.9 x 18.7	9.2	22	24	32	56	24	40
CULZEAN 1 & 2	258 / 24	13.8 x 18.7	9.2	12	15	16	24	12	20
GLAMIS	527 / 49	28.2 x 18.7	9.2	22	25	32	56	24	40
GLAMIS 1 & 2	269 / 25	14.1 x 18.7	9.2	12	15	16	24	12	20
STIRLING	1195 / 111	23.3 x 51.2	8.5	44	41	56	95	36	70
STIRLING 1 & 2	581 / 54	23.3 x 24.9	8.5	22	20	24	42	18	30
BRAEMAR	398 / 37	26.9 x 14.8	9.2	22	24	24	40	24	30
BRAEMAR 1 & 2	205 / 19	13.5 x 14.8	9.2	12	9	8	21	12	12

Please note, the above measurements of the partitioned meeting spaces are an approximation and may vary slightly. Please speak to a sales & events representative for exact measurements and suitability for your requirements.

SHERATON GRAND HOTEL & SPA

1 Festival Square

Edinburgh, EH3 9SR

T +44 (0) 131 229 9131

sheraton.com/grandedinburgh